

Surface Mount Red / Green LED

3.5mm × 2.8mm

multicomp PRO

**RoHS
Compliant**

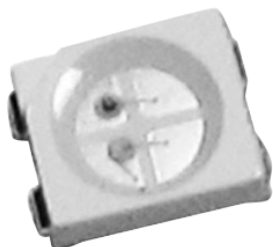

Features

- Dimensions: 3.5mm × 2.8mm × 1.9mm.
- Wide Viewing Angle.

Applications

- Automotive: Backlighting in dashboard and switch.
- Telecommunication: Indicator and Backlighting in telephone and fax.
- Flat Backlight for LCD switch and symbol.

Optical Properties

Chip		Lens Colour
Material	Emitted Colour	Water Clear
(InGaAlP)	Red	
(InGaAlP)	Green	

Absolute Maximum Ratings at TA=25°C

Parameter	Symbol	Red	Green	Unit
Power Dissipation	P _d	62		mW
Forward Current	I _F	25		mA
Peak Forward Current*1	I _{FP}	100		mA
Reverse Voltage	V _R	5		V
Operating Temperature	T _{opr}	-40°C To +85°C		
Storage Temperature	T _{stg}	-40°C To +85°C		

Notes:

*1: Pulse width ≤ 0.1ms, Duty cycle ≤ 1/10

Electrical / Optical Characteristics at TA=25°C

Parameter	Symbol	Device	Min.	Typ.	Max	Unit	Test Conditions
Forward Voltage	V _F	Red Green	1.8 1.8	—	2.6 2.6	V	I _F =20mA
Reverse Current	I _R		—	—	10	μA	V _R =5V
Dominant Wavelength	λ _D		617 568	—	629 576	nm	I _F =20mA
Luminous Intensity	I _v		225 100	—	500 225	mcd	
Viewing Angle	2θ _{1/2}		—	120	—	Deg.	

Remarks:

If special sorting is required (e.g. binning based on forward voltage, luminous intensity, or chromaticity), the typical accuracy of the sorting process is as follows:

1. Wavelength: ±1nm
2. Luminous Intensity: ±15%
3. Forward Voltage: ±0.1V

Newark.com/multicomp-pro
Farnell.com/multicomp-pro
sg.element14.com/b/multicomp-pro

multicomp PRO

Surface Mount Red / Green LED

3.5mm × 2.8mm

multicomp PRO

Typical Electrical/Optical Characteristics Curves

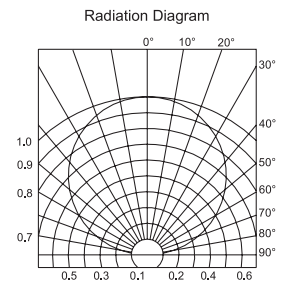
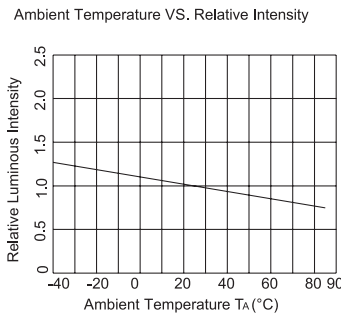
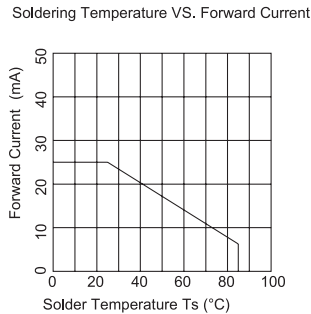
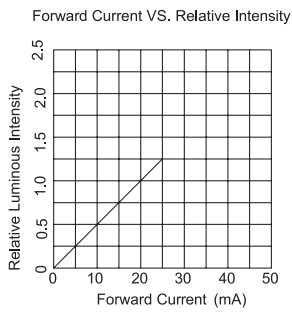
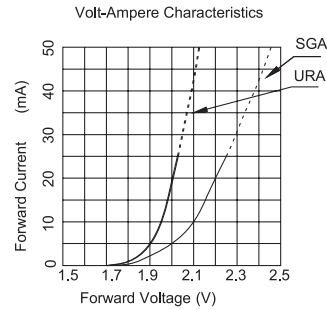
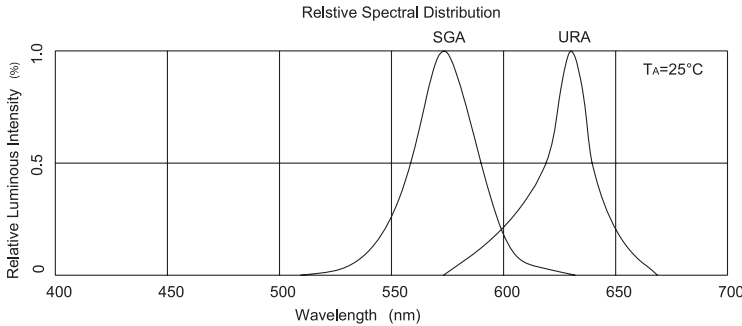

Package Dimensions

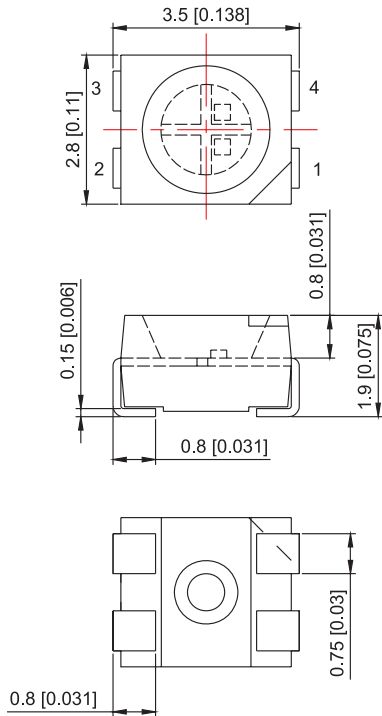

Dimensions : Millimetres (Inches)

Recommended soldering pattern

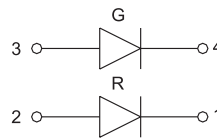
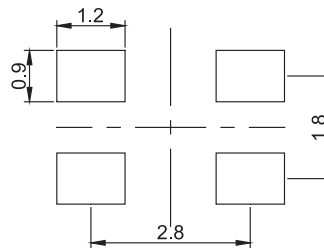

Notes:

1. All dimensions are in millimetres.
2. Tolerance is ± 0.15 unless otherwise noted.
3. Specifications are subject to change without notice.

Newark.com/multicomp-pro
 Farnell.com/multicomp-pro
 sg.element14.com/b/multicomp-pro

multicomp PRO

Surface Mount Red / Green LED

3.5mm × 2.8mm

multicomp PRO

VF Rank

Red

Rank	VF(V)		Conditions
	Min	Max	
B	1.8	2	F=20mA
C	2	2.2	
D	2.2	2.4	
E	2.4	2.6	

Tolerance:±0.1V

Green

Rank	VF(V)		Conditions
	Min	Max	
B	1.8	2	F=20mA
C	2	2.2	
D	2.2	2.4	
E	2.4	2.6	

λD Rank

Red

Rank	λD(nm)		Conditions
	Min	Max	
5	617	621	IF=20mA
6	621	625	
7	625	629	

Tolerance:±1nm

Green

Rank	λD(nm)		Conditions
	Min	Max	
9B	568	570	IF=20mA
1C	570	572	
2C	572	574	
3C	574	576	

IV Rank

Red

Rank	IV(mcd)		Conditions
	Min	Max	
R	225	295	IF=20mA
S	295	385	
T	385	500	

Tolerance:±15%

Green

Rank	IV(mcd)		Conditions
	Min	Max	
S	100	130	IF=20mA
T	130	170	
U	170	225	

Reliability Test Items and Conditions

Test Item	Reference	Test Conditions	Time	Quantity	Criterion
Thermal Shock	JIS-C7021 A-4	100°C±5°C 15min ↓↑ -40°C±5°C 15min	200 cycles	22	0/22
High Temperature Storage	JEITA ED- 4701 200 201	Ta=100°C	1000 hrs.		
Low Temperature Storage	JEITA ED- 4701 200 202	Ta=-40°C			
High Temperature High Humidity Storage	JIS-C7021 B-11	Ta=85, RH=85%			
Resistance to Soldering Heat	GB/T 4937	Tsol*=(260±5)°C 10secs.			
Life Test	JESD22-A108	Ta=25°C±5°C IF=20mA			
High Temperature Life Test		Ts=55°C±5°C IF=20mA			

Note: Tsol-Temperature of tin liquid.

Newark.com/multicomp-pro
Farnell.com/multicomp-pro
sg.element14.com/b/multicomp-pro

multicomp PRO

Surface Mount Red / Green LED

3.5mm × 2.8mm

multicomp PRO

Item	Symbol	Test Conditions	Failure Criteria	
			MIN.	MAX.
Forward Voltage	VF(V)	IF=20mA	-	U.S.L*1.1
Reverse Current	IR(uA)	VR=5V	-	10uA
Luminous Flux	IV(LM)	IF=20mA	L.S.L*0.7	-

Note: 1.USL:Upper Specification Level
2.LSL:Lower Specification Level

Soldering Profile

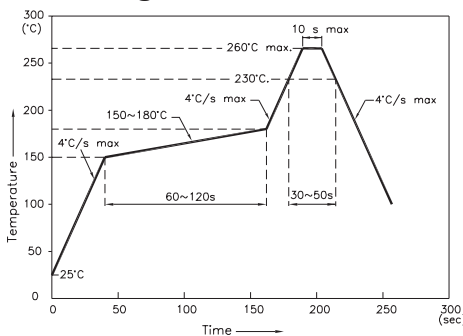

Recommend the reflow temperature 245°C (±5°C) The maximum soldering temperature should be limited to 260°C.
Reflow soldering should not be done more than two times.
Stress on the LEDs should be avoided during heating in soldering process.
After soldering, do not deal with the product before its temperature drop down to room temperature.

Tape Specifications

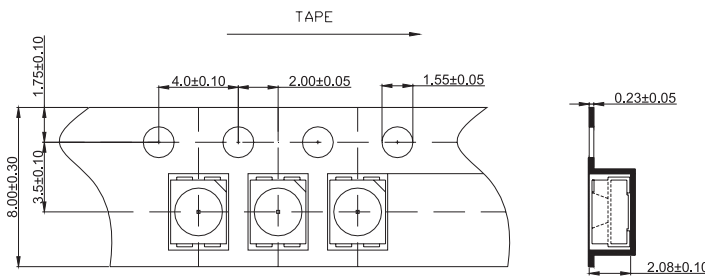

Part Number Table

Description	Part Number
SMD LED, 3528, Red / Green, 500/225mcd, 120°	MP005919

Dimensions : Millimetres

Important Notice : This data sheet and its contents (the "Information") belong to the members of the AVNET group of companies (the "Group") or are licensed to it. No licence is granted for the use of it other than for information purposes in connection with the products to which it relates. No licence of any intellectual property rights is granted. The Information is subject to change without notice and replaces all data sheets previously supplied. The Information supplied is believed to be accurate but the Group assumes no responsibility for its accuracy or completeness, any error in or omission from it or for any use made of it. Users of this data sheet should check for themselves the Information and the suitability of the products for their purpose and not make any assumptions based on information included or omitted. Liability for loss or damage resulting from any reliance on the Information or use of it (including liability resulting from negligence or where the Group was aware of the possibility of such loss or damage arising) is excluded. This will not operate to limit or restrict the Group's liability for death or personal injury resulting from its negligence. Multicomp Pro is the registered trademark of Premier Farnell Limited 2019.

Newark.com/multicomp-pro
Farnell.com/multicomp-pro
sg.element14.com/b/multicomp-pro

multicomp PRO